



F225

High Load Ultra Low Profile Loadcell Standard Ranges 5 and 10tonne (50 and 100kN)

- ◆ Ultra low profile
- ◆ Fail-safe failure mode
- ◆ Hardened stainless steel
- ◆ IP67 sealing option
- ◆ Standard 2 year warranty



Geometry: Ultra low profile axial loadcell for use in force measurements in compression.

The ultra slim design provides for ease of installation beneath heavy machinery mounts, hydraulic rams or interposed within series mechanical compression assemblies.

In the event of structural failure of the loadcell the resulting vertical movement of the supported load including normal deflection will not exceed 2.5mm.

We are happy to design variants of this loadcell to meet your specific requirements. Please consult our engineering department.

Details of our other loadcell families can be found in the Loadcell Specifier Guide. If you require a copy please contact our sales department or look on our web site at www.novatechloadcells.co.uk.

Ordering Codes:	See the loadcell ordering code sheet for more details. Add range in the required units.		
F225CFR0H0	Compression, IP65, unrationalised	F225CFR0HN	Compression, IP65, rationalised
Change the R to an S for IP67 sealing.			

F225 Specification

Parameter	Value	Unit
Non-linearity - Terminal	±0.5	% RL
Hysteresis	±0.5	% RL
Creep - 20 minutes	±0.05	% AL
Repeatability	±0.02	% RL
Rated output - Nominal	2.3	mV/V
Rated output - Rationalised	2.0	mV/V
Rationalisation tolerance	±0.5	% RL
Zero load output	±4	% RL
Temperature effect on rated output per °C	±0.005	% AL
Temperature effect on zero load output per °C	±0.005	% RL
Temperature range - Compensated	-10 to +50	°C
Temperature range - Safe	-10 to +80	°C
Excitation voltage - Recommended	10	V
Excitation voltage - Maximum	10	V
Bridge resistance	350	Ω
Insulation resistance - Minimum at 50Vdc	500	MΩ
Overload - Safe	50	% RL
Overload - Ultimate	300	% RL
Sealing - R option	IP65	
Sealing - S option	IP67	
Weight - nominal (excluding cable)	0.8	kg

All standard ranges are manufactured in stainless steel.

Structural stiffness - Nominal					
Range (kN)	Stiffness (N/m)	Range (kN)	Stiffness (N/m)	Range (kN)	Stiffness (N/m)
50	2.1×10^{10}	100	4.2×10^{10}		

Notes

1. AL = Applied load.
2. RL = Rated load.
3. Temperature coefficients apply over the compensated range.
4. The load must be applied directly through the central loading axis.

Connections

The loadcell is fitted with 2 metres of PVC insulated 4 core screened cable type 7-2-4C.

Excitation + = Red Signal + = Yellow Screen = Orange

Excitation - = Blue Signal - = Green

The screen is not connected to the loadcell body.

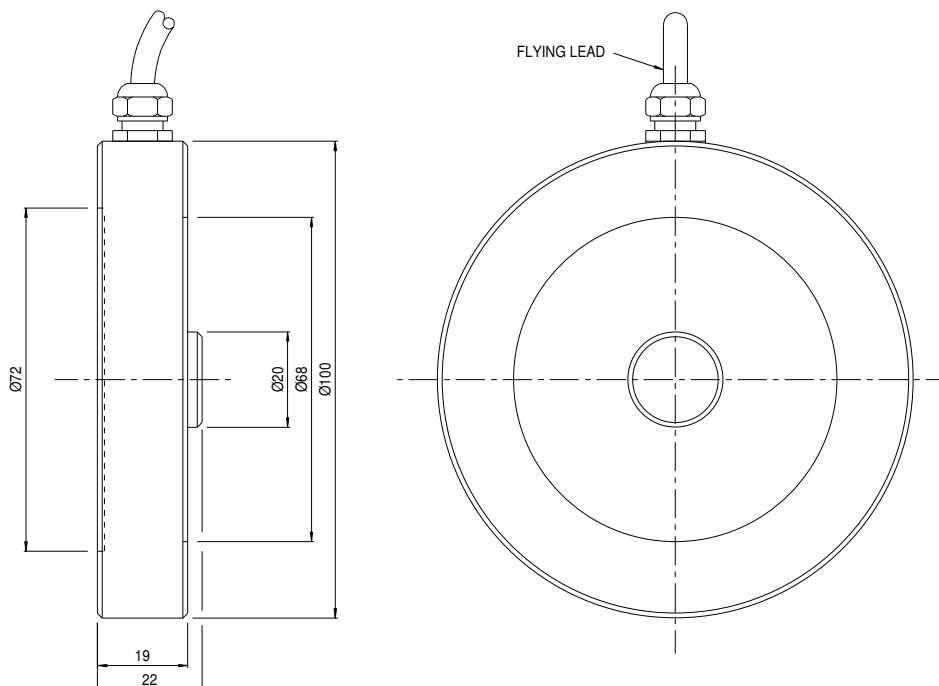

Novatech reserves the right to vary the foregoing details without prior notice

08/2007

NOVATECH MEASUREMENTS LTD

83 CASTLEHAM ROAD, ST LEONARDS ON SEA, EAST SUSSEX, TN38 9NT, ENGLAND

Tel: 01424 852744

email: info@novatechloadcells.co.uk

Fax: 01424 853002

www.novatechloadcells.co.uk