



F322

Accelerator Pedal Force Loadcell

Standard Range 250N (25kg)

- ◆ Off centre loading compensation
- ◆ Simple cable tie or screw fixing
- ◆ Anti-slip rubber mat
- ◆ Removable loading plate
- ◆ Output rationalised to 1mV/V
- ◆ Lightweight aluminium alloy construction

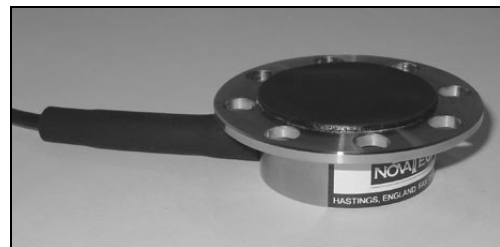

The F322 is a compact, high accuracy low profile loadcell for measuring accelerator pedal application forces. The loadcell is robust in construction with a maximum force range of 250N (25kg). Its multi-hole fixing allows simple attachment to any shape pedal using screws or cable ties. The low profile design maintains the accelerator pedals ergonomic geometry. Low mass aluminium alloy construction reduces the mass influence upon the accelerator pedal in dynamic testing.

Additional information can be found in the Pedal Force Engineering Application Sheet. If you require other force ranges the F304 or F323 may be suitable.

We are happy to design variants of this loadcell to meet your specific requirements. Please consult our engineering department.

Details of our other loadcell families can be found in the Loadcell Specifier Guide. If you require a copy please contact our sales department or look on our web site at www.novatechloadcells.co.uk.

| | | | |
|------------------------|---|--|--|
| Ordering Codes: | See the loadcell ordering code sheet for more details. Add range in the required units. | | |
| F322CFR0KN | Compression, IP65, rationalised | | |

F322 Specification

| Parameter | Value | Unit |
|---|---------------------|------|
| Non-linearity - Terminal | ±0.05 | % RL |
| Hysteresis | ±0.05 | % RL |
| Creep - 20 minutes | ±0.05 | % AL |
| Repeatability | ±0.02 | % RL |
| Rated output - Rationalised | 1.0 | mV/V |
| Rationalisation tolerance | ±0.1 | % RL |
| Zero load output | ±4 | % RL |
| Temperature effect on rated output per °C | ±0.004 | % AL |
| Temperature effect on zero load output per °C | ±0.01 | % RL |
| Temperature range - Compensated | -10 to +50 | °C |
| Temperature range - Safe | -10 to +80 | °C |
| Excitation voltage - Recommended | 10 | V |
| Excitation voltage - Maximum | 20 | V |
| Bridge resistance | 700 | Ω |
| Insulation resistance - Minimum at 50Vdc | 500 | MΩ |
| Inclined load error - concentric at 3° | ±0.25 | % RL |
| Structural stiffness | 8 x 10 ⁶ | N/m |
| Overload - Safe | 50 | % RL |
| Overload - Ultimate | 200 | % RL |
| Sideload - Safe | 100 | % RL |
| Sealing | IP65 | |
| Weight - Nominal (excluding cable) | 80 | g |

The standard range is manufactured in aluminium alloy.

When this loadcell is rationalised the resistors are housed in a capsule located in the loadcell cable 100mm from the free end. Capsule dimensions are Ø10mm by 57mm.

Notes

1. AL = Applied load.
2. RL = Rated load.
3. Temperature coefficients apply over the compensated range.

Connections

The loadcell is fitted with 2 metres of flexible polyurethane jacketed 4 core screened cable.

Excitation + = Red Signal + = Yellow Screen = Orange
 Excitation - = Blue Signal - = Green

The screen is not connected to the loadcell body.

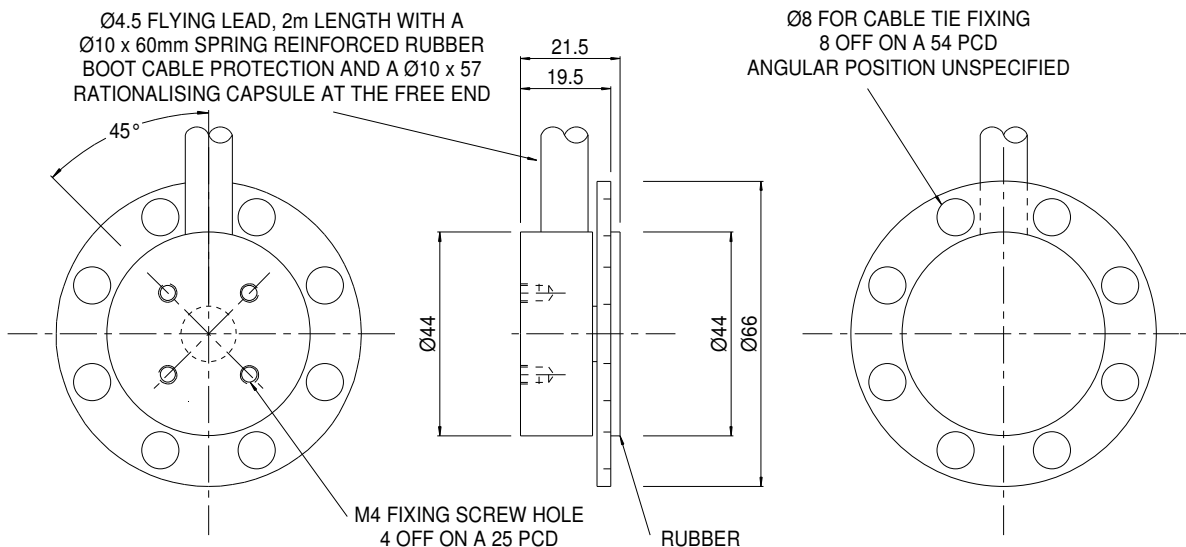

Novatech reserves the right to vary the foregoing details without prior notice

01/2008

NOVATECH MEASUREMENTS LTD

83 CASTLEHAM ROAD, ST LEONARDS ON SEA, EAST SUSSEX, TN38 9NT, ENGLAND

Tel: 01424 852744

email: info@novatechloadcells.co.uk

Fax: 01424 853002

www.novatechloadcells.co.uk