

## Set-up Wheel Loadcells Standard Ranges 125 and 250kg

- ◆ Ball transfer base
- ◆ Off axis loading compensation
- ◆ Capacity 250 or 500kg per wheel
- ◆ Standard 2 year warranty



This F256 loadcell assembly is designed specifically to be easily fitted to customer designed set-up wheels. Incorporating a ball transfer base means that the car can easily be positioned precisely in the workshop. Off axis loading due to camber angles are allowed for with the loadcells built in compensation. With the cable exiting through the loadstud and fitted with a connector, levelling of the wheel is achieved by rotation of the loadcell in the set-up wheel. With two loadcells fitted to each wheel, giving a capacity of up to 250kg or 500kg, typical accuracy is better than 0.25kg or 0.5kg (refer to F256 Data Sheet for full performance specification). All the variants of this loadcell have F256-Zxxxx codes, the most common is the F256-Z0795.

We can supply TR150 or TR200/2 battery powered loadmeters for use with these loadcells. If you require signal conditioning to interface the loadcells to your workshop equipment the SGA, SY011 and SY018 amplifiers are available with either voltage or current outputs. The DSC USB loadcell digitiser or the T24-SYSC telemetry system can be used to provide a precision computer interface.

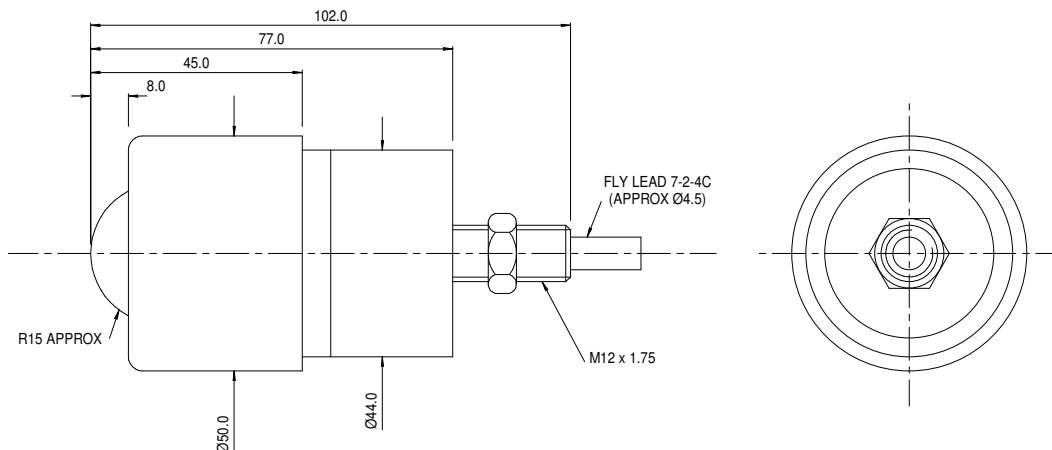

Novatech reserves the right to vary the foregoing details without prior notice

05/2011

### NOVATECH MEASUREMENTS LTD

83 CASTLEHAM ROAD, ST LEONARDS ON SEA, EAST SUSSEX, TN38 9NT, ENGLAND

Tel: 01424 852744

email: [info@novatechloadcells.co.uk](mailto:info@novatechloadcells.co.uk)

Fax: 01424 853002

[www.novatechloadcells.co.uk](http://www.novatechloadcells.co.uk)

